

APPROVED

CAR PARK

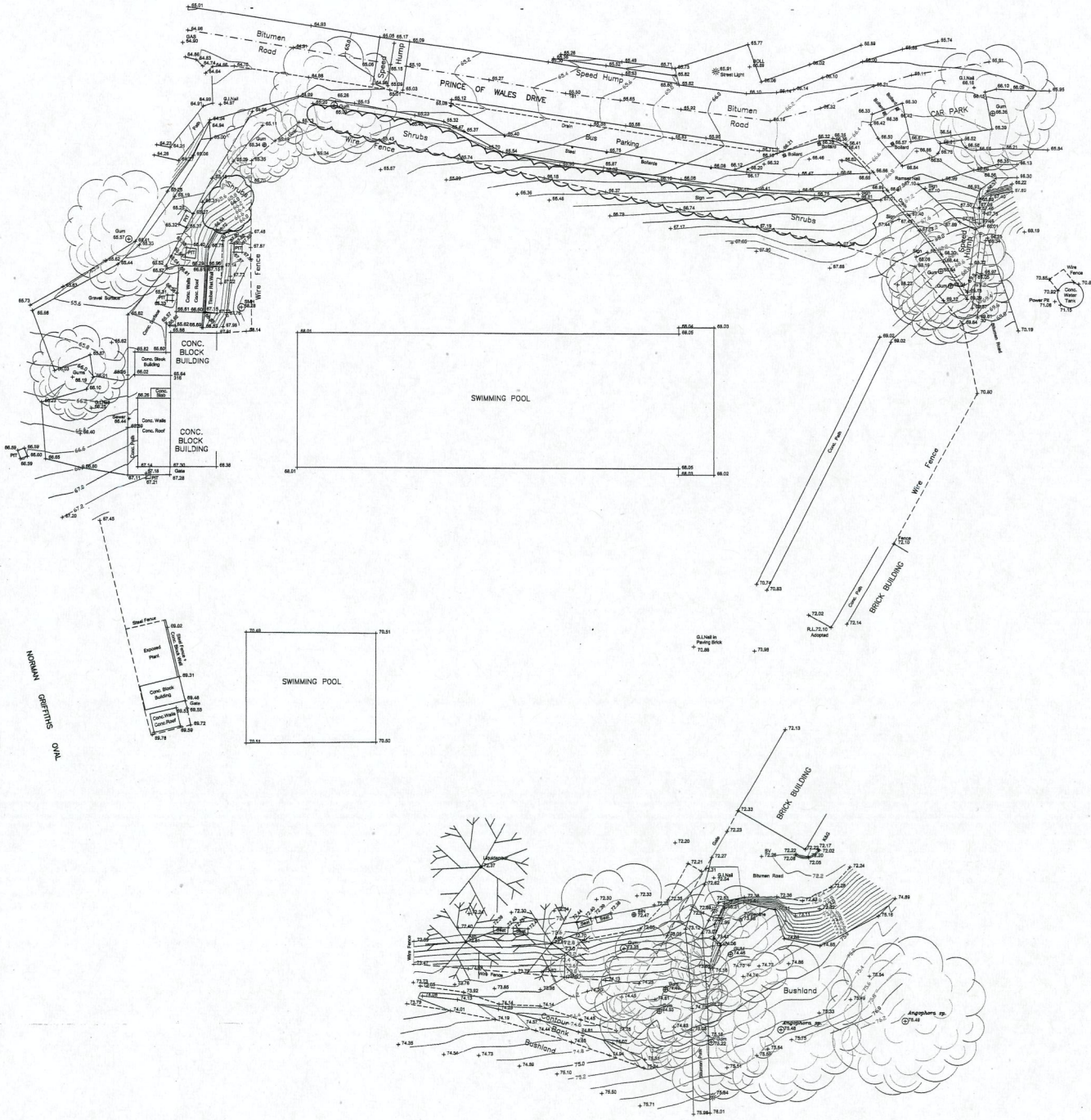

- Notes
1. Level Datum : AHD vice drawing 26762AD1.dwg (30/4/1999)
 2. Origin of Levels : Cor. Concrete Path RL72.10
 3. Underground utilities have not been investigated and it is recommended that a 'Dig Before You Dig' search and ground scanning be initiated prior to any design, excavation or construction.
 4. Any proposed new buildings, where the location is critical in relation to existing boundaries, buildings or features, should be set out by a surveyor.
 5. This detail plan is to be used for a conceptual proposal only and is a representation of detail visible during the course of the survey. Existing services may not be recorded.
 6. Heights should not be interpolated from contour lines as they are only a general representation of ground gradient.
 7. Building and architectural information shown on this plan indicates approximate position only and must not be used for building design purposes without independent verification and data interpretation.
 8. Tree location and canopy spread are approximate only.
 9. denotes Light Pole
 10. SMH denotes Sewer Access Pit
 11. This plan shows survey information requested by Suters Architects and does not represent a complete site survey.

RECEIVED
05 OCT 2009
SURVEY SERVICE CENTRE

© Anderson Surveying Pty Ltd. 2009

ANDERSON SURVEYING PTY.LTD. ACN 105 121 819
31 MAIN STREET LITHGOW
PO BOX 397 LITHGOW 2790
PH. (02) 6351 3476 FAX (02) 6351 3477 Email andsurvey@bigpond.net.au

DATE	4/6/2009
AMENDED	
SURVEYOR	RS
DRAWN	RS
CHECKED	RS

CONTOUR & DETAIL SURVEY OF PART OF
WEST PYMBLE SWIMMING POOL COMPLEX

SCALE - 1:250 (A1)

DWG No	09147-1
JOB No	09147
Drawing Ref.	09147.dwg (A1)